

Component Placing, Electrical

Applicable for T700

Contents

1	Mounting drawing table	2
2	Mounting drawing.....	3
2.1	Side A	4
2.2	Side B	5
3	Revision history.....	6

1 Mounting drawing table

Board Number	Drawing	Comments
1209-1364	1209-1366	

By using the “Search” function and enter the component name you can find the position of the component
(Use Adobe Reader 7.0 or a later version). Example: You can see the component name highlighted on the circuit board (use zoom to enlarge).

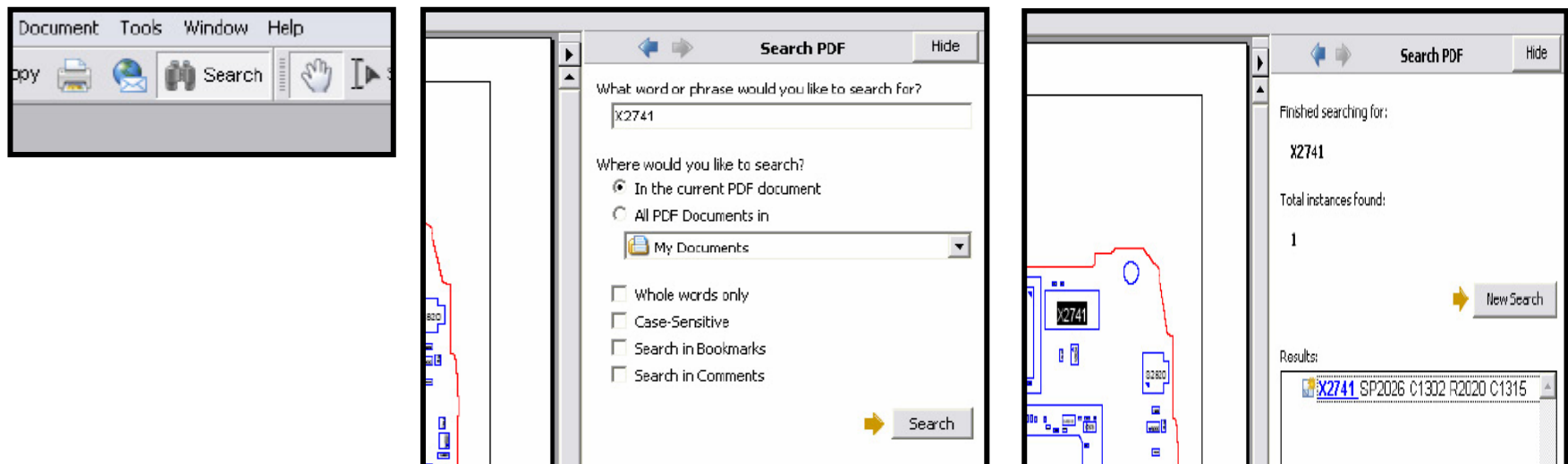

2 Mounting drawing



2.1 Side A

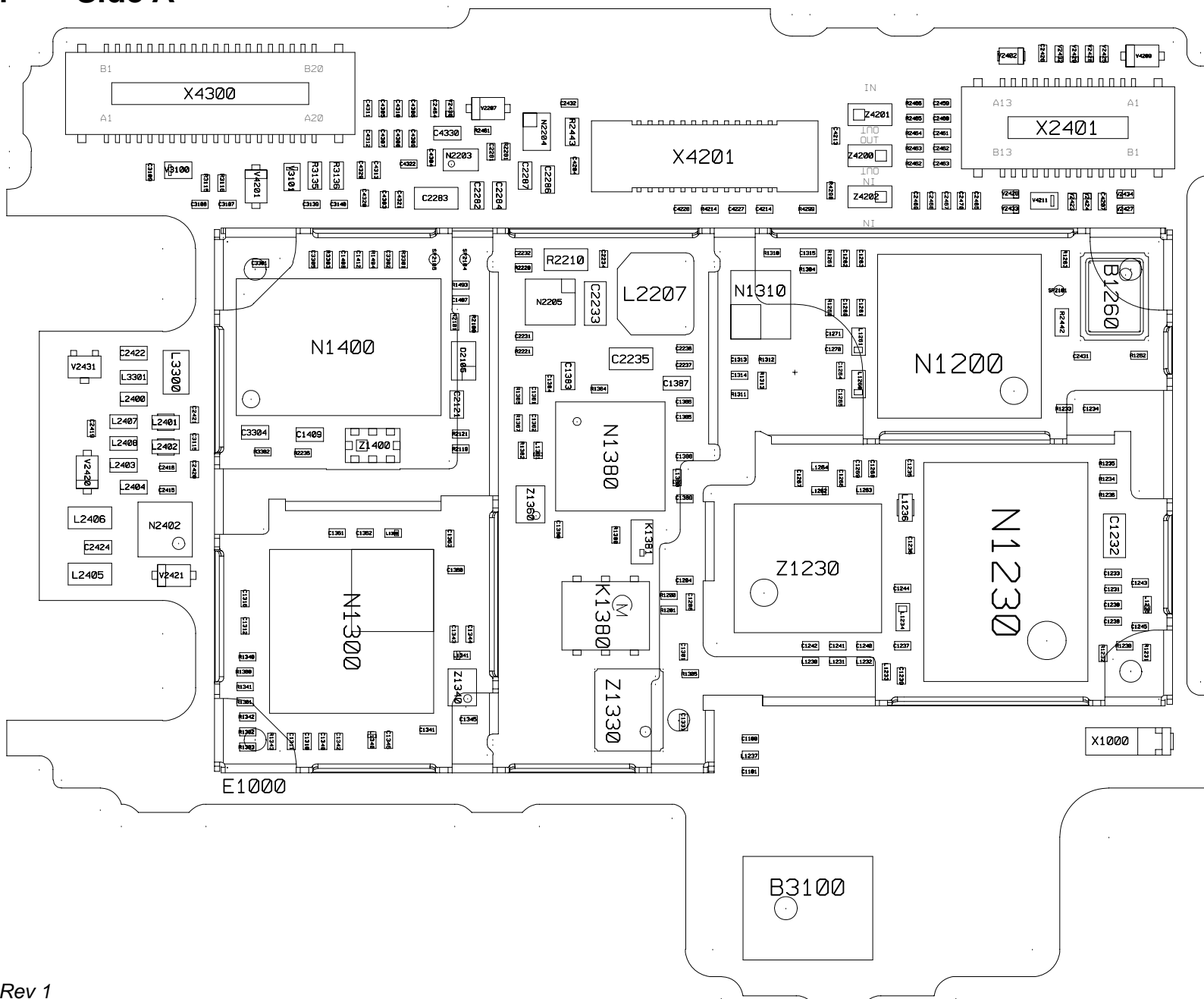

3 Revision history

Rev.	Date	Changes / Comments
1	2008-09-26	Initial release